

## Nyloc Insert Nut

**Thread Type:** Metric - Coarse

**Thread Direction:** Right Hand

**Material:** Carbon Steel

**Class Grade:** High Tensile Class 10

**Finish:** Zinc Plated

**Corrosion Protection Level:** Moderate

**Standard:** DIN 985

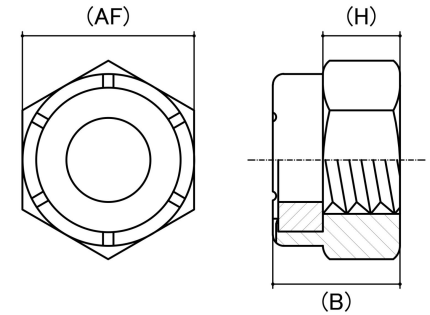

*CAD drawings shown for graphic representation only.\**

Size	Thread Pitch (mm)	Thread Type	Overall Nut Height (B) (mm)		Hex Height (H) (mm)	Across Flats (AF) (mm)		Spanner Size (AF) (mm)	sku (qfind)
			Min	Max	Nom	Min	Max		
M6	1.00	Coarse	5.70	6.00	4.00	9.78	10.00	10	41N6C10
M8	1.25	Coarse	7.64	8.00	5.50	12.73	13.00	13	41N8C10
M10	1.50	Coarse	9.64	10.00	6.50	16.73	17.00	17	41N10C10
M12	1.75	Coarse	11.57	12.00	8.00	18.67	19.00	19	41N12C10
M14	2.00	Coarse	13.30	14.00	9.50	21.67	22.00	22	41N14C10
M16	2.00	Coarse	15.30	16.00	10.50	23.67	24.00	24	41N16C10
M18	2.50	Coarse	17.66	18.50	13.00	26.16	27.00	27	41N18C10
M20	2.50	Coarse	18.67	20.00	14.00	29.16	30.00	30	41N20C10
M24	3.00	Coarse	23.15	24.00	15.00	35.16	36.00	36	41N24C10
M30	3.50	Coarse	28.70	30.00	19.00	45.00	46.00	46	41N30C10
M36	4.00	Coarse	34.40	36.00	25.00	53.80	55.00	55	41N36C10
M42	4.50	Coarse	40.40	42.00	29.00	63.80	65.00	65	41N42C10
M48	5.00	Coarse	46.40	48.00	36.00	73.80	75.00	75	41N48C10
M56	5.50	Coarse	54.00	56.00	42.00	82.80	85.00	85	41N56C10
M64	6.00	Coarse	62.00	64.00	50.00	92.80	95.00	95	41N64C10

**Disclaimer:**

Dimensional data and technical information was obtained from publically available sources and not acquired through standard agencies. It has been completed and compiled for reference purposes only; where discrepancies are found they are subject to change without notice. Bolt & Nut Australia makes no warranties or representations regarding the accuracy and validity of the compiled information and data. Contact the relevant standard authorities for accurate and detailed information.

\* CAD drawings may not reflect diameter, thread length or overall length.